



For Sale

9 Marlborough Close, Kettering

Guide Price £350,000



Located in a popular area is this very well presented four bedroom detached family home. It comes with driveway parking for a number of vehicles and a garage.

This property is situated on a no through road. It is very close to some great primary and secondary schools. It is also just a short walk to all of the usual amenities and is on a bus route. Kettering town centre along with the train station are again very close by. Upon entering this property you step into a bright hallway. The guest cloakroom leads off from this space. The sitting room/dining room is a very bright room, there is light entering this space from both ends of the room. You will find an air conditioning unit fitted. In the kitchen you will find plenty of low level and wall mounted kitchen cabinets and some of the kitchen appliances are integral. On the first floor there is a good size landing. You will find four great size double bedrooms and a well appointed family bathroom on this level too. The master bedroom has an air conditioning unit fitted. Outside the property there is driveway parking for a number of vehicles and a garage with electrics fitted. To the rear of the property there is a very well manicured private garden. Please contact MIRANDA your local agent for more information.

Miranda Menzies

07979042925

miranda@thepropertyexperts.co.uk

Property and Services information.

Mobile Coverage: 4G coverage is available in the area-please check with the provider.

Broadband Availability: Ultrafast broadband (FTTC) is available in this area.

<https://www.ofcom.org.uk/phones-telecoms-and-internet/advice-for-consumers/advice/ofcom-checker>



The Property Experts UK

01536609970

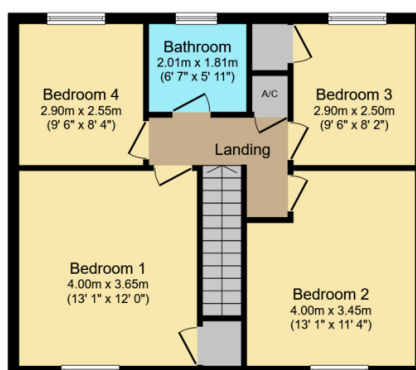
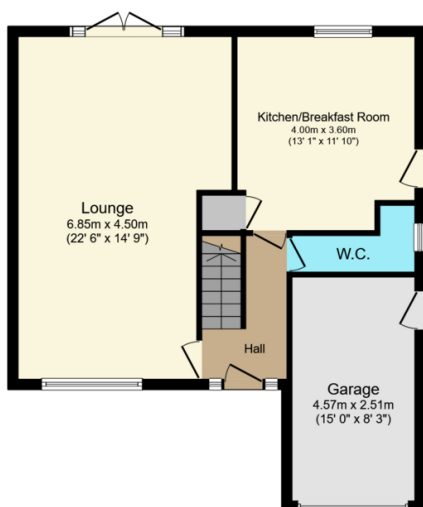

- Located in a popular area.
- Close to great schools and all of the usual amenities.
- Situated on an enviable plot.
- Guest cloakroom.
- Four double bedrooms.
- Driveway parking for multiple vehicles.
- Garage.
- Bright and spacious throughout.
- Air conditioning units fitted.
- Good local schools.

Total floor area: 119.6 sq.m. (1,288 sq.ft.)

This floor plan is for illustrative purposes only. It is not drawn to scale. Any measurements, floor areas (including any total floor area), openings and orientations are approximate. No details are guaranteed, they cannot be relied upon for any purpose and do not form any part of any agreement. No liability is taken for any error, omission or misstatement. A party must rely upon its own inspection(s). Powered by www.Propertybox.io

