



**For Sale**

**19 Rydal Close, Corby**

**Offers In Excess Of  
£300,000**

 3

 2

 2

**Located in the popular Oakley Vale development of Corby is this beautifully presented three bedroom detached family home. It comes with driveway parking and a single garage.**

This property is located in a desirable area close to great schools and all of the usual amenities. The property has recently undergone a number of improvements by the current owners to include a new kitchen along with appliances. New bathrooms, ground level flooring and first floor carpets. The garden has been newly landscaped and a new patio laid. Upon entering this property you step into a the hallway. The sitting room is a bright space and has aspect windows. The kitchen also has a number of windows. There are plenty of low level and wall mounted kitchen cabinets and most of the kitchen appliances are integral. You will find a guest cloakroom leading off from this space. On the first floor there is a spacious landing with a built in storage cupboard. There are two double bedrooms and one single. The double bedroom complete with its own ensuite bathroom. There is a well appointed family bathroom on this level too. Outside the property there is driveway parking and a single garage. There is a lawned garden to the front/side and gated access to the rear garden. The rear garden is a good size and very private. There is a large patio area great for outside entertaining. Please contact MIRANDA your local agent for more information.

**Miranda Menzies**

07979042925

miranda@thepropertyexperts.co.uk

Property and Services information.

Mobile Coverage:4G coverage is available in the are-please check with the provider.

Broadband Availability: Ultrafast broadband (FTTC) is available in this area.

<https://www.ofcom.org.uk/phones-telecoms-and-internet/advice-for-consumers/advice/ofcom->



**The Property Experts UK**

01536609970



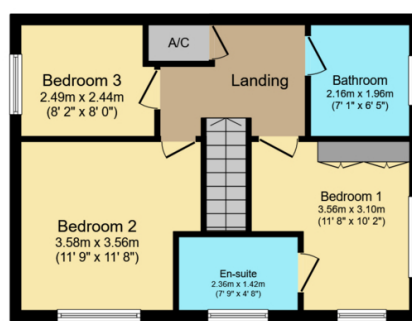
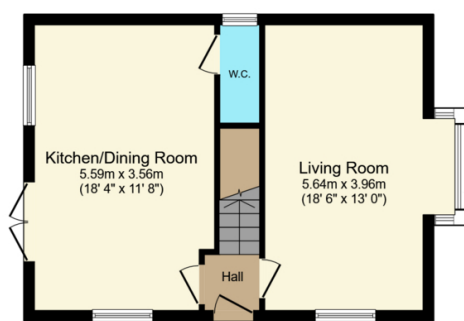

Total floor area: 87.7 sq.m. (944 sq.ft.)

This floor plan is for illustrative purposes only. It is not drawn to scale. Any measurements, floor areas (including any total floor area), openings and orientations are approximate. No details are guaranteed, they cannot be relied upon for any purpose and do not form any part of any agreement. No liability is taken for any error, omission or misstatement. A party must rely upon its own inspection(s). Powered by www.Propertybox.io

- Stunning three bedroom detached family residence.
- Close to some good schools.
- Close to all of the usual amenities.
- Garage and driveway.
- Large open plan kitchen/family room.
- Well manicured private rear garden.
- Newly fitted kitchen and bathrooms.
- Newly fitted carpets.
- EPC B.

