



**For Sale**

**16 Elizabeth Road, Rothwell**

**£240,000**

 **3**

 **1**

 **1**

**Three bedroom semi detached home that is show home style and ready to move into with high quality feature kitchen. This property is joining the market chain free.**

This beautifully refurbished three bedroom semi detached home offers a rare opportunity to own a property finished to an exceptional standard. A genuine turnkey home, ready for immediate enjoyment.

The property benefits from sleek and modern décor, recently renovated with grey and white palette, and bespoke finishes, some of these include chrome sockets, high quality light fittings and flooring throughout.

Accommodation available;

On entry there is a spacious porch, this includes two storage areas. A practical utility space and direct access to the rear garden.

An inviting lounge, cosy, yet stylish.

A stunning open plan kitchen diner complete with breakfast bar, appliances include a five rings gas hob, oven, built-in microwave, and integrated dishwasher. This room is finished with modern French doors opening onto the private rear garden.

Three well proportioned bedrooms, the master benefitting from wall to wall mirrored wardrobes.

**Miranda Menzies**

07979042925

[miranda@thepropertyexperts.co.uk](mailto:miranda@thepropertyexperts.co.uk)



**The Property Experts UK**

01536609970





**Ground Floor**  
Floor area 64.5 sq.m. (694 sq.ft.)

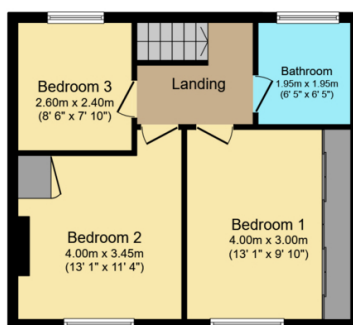

**First Floor**  
Floor area 43.7 sq.m. (471 sq.ft.)

**Total floor area: 108.2 sq.m. (1,165 sq.ft.)**

This floor plan is for illustrative purposes only. It is not drawn to scale. Any measurements, floor areas (including any total floor area), openings and orientations are approximate. No details are guaranteed, they cannot be relied upon for any purpose and do not form any part of any agreement. No liability is taken for any error, omission or misstatement. A party must rely upon its own inspection(s). Powered by [www.Propertybox.io](http://www.Propertybox.io)

- Showstopper Kitchen
- Fully renovated throughout to a very high standard
- Exceptional fixtures and fittings
- Private rear garden
- Ample storage throughout
- Master with wall to wall mirrored wardrobes
- First time buyer ready
- New flooring throughout
- Turnkey Property
- Good schools located nearby

