



For Sale

5 Sir Thomas White Close, Warwick

£185,000

2

2

3

170 m2

74 m2

Nathaniel Cleaver

07793 363210

nathaniel@thepropertyexperts.co.uk

*** TOP FLOOR APARTMENT WITH TWO DOUBLE BEDROOMS & TWO BATHROOMS BEING OFFERED FOR SALE WITH NO ONWARD CHAIN ***

This spacious and modern 2nd floor apartment is ideal for first time buyers, buy to let investors or somebody looking to stay in Warwick and downsize.

The property is positioned close to the M40, Warwick and Leamington Spa Town centres and just over 1 mile to Warwick Parkway train station.

The property comprises in brief of; secure communal entrance hall, hallway, lounge / dining area and kitchen just off it. There are two double bedrooms, the master benefiting from built in wardrobes and en suite shower facilities and there is also a white modern bathroom along with large storage cupboard off the hallway.

The apartment also benefits from double glazing and an allocated parking space. The property is a stones throw away from the canal to enjoy walks, a bike ride or simply take in the picturesque views.

The apartment is vacant and being offered for sale with no onward chain and a viewing is highly recommended.



 **The Property Experts**

**The Property Experts -
Leamington Spa**

01926436105

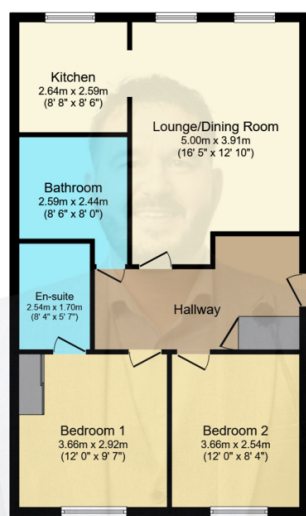

Total floor area: 77.5 sq.m. (834 sq.ft.)

This floor plan is for illustrative purposes only. It is not drawn to scale. Any measurements, floor areas (including any total floor area), openings and orientations are approximate. No details are guaranteed, they cannot be relied upon for any purpose and do not form any part of any agreement. No liability is taken for any error, omission or misstatement. A party must rely upon its own inspection(s). Powered by www.Propertybox.io

- Modern Top Floor Apartment
- Two Double Bedrooms
- Bathroom & En Suite To Master
- Living / Dining Area
- Integrated Kitchen
- Large Internal Storage Cupboard
- Allocated Parking
- No Onward Chain
- EPC Rating - D

