



Whitehouse Apartments

SOUTHWARK • GUIDE PRICE £550,000

A one bedroom apartment in London SE1 with 24 concierge & resident facilities perfectly placed for The London School of Economics.

DESCRIPTION

A spacious one-bedroom apartment in London, SE1 – perfectly located for The London School of Economics (LSE) and ideal as a London base. With a wide range of facilities, including gym, swimming pool, sauna, communal rooftop garden and 24-hour concierge service, Whitehouse Apartments is an exceptionally well-run development. The property is on the sixth floor with City views with plenty of natural light.

Situated by Jubilee Gardens, the London Eye and The River Thames, the apartment offers fantastic access to LSE and the property offers fully integrated kitchen with space for a dining table and chairs a large reception room with space to dine and a double bedroom with full height wardrobes. The family bathroom is arranged with a shower over bath, sink and WC.

Additional information

Please note that we have been unable to confirm the date of the next review for the ground rent. You should ensure that you or your advisors make your own inquiries.

We have been informed that the primary external wall materials of the building/block have been assessed for fire safety. The assessor concluded that the fire risk of the external wall materials is sufficiently low that no remedial works are required. If you have any further questions, you should seek independent professional advice

TERMS

Price: Guide Price £550,000

Tenure: Share of Freehold

Ground Rent: £100.00

Service Charge: £6,800.00

Local Authority: Lambeth Council









**Approx. Gross Internal Area = 49m square
= (528ft square)**

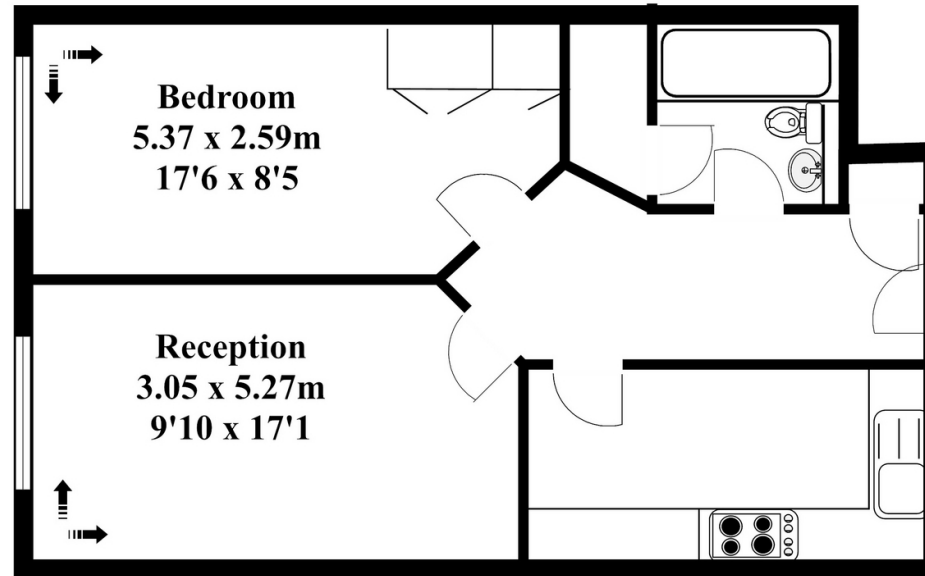

Robbie Gittins

Partner

0203 879 0723

robbie.gittins@hardinggreen.com

Important Notice. We would like to inform prospective purchasers that these sales particulars have been prepared as a general guide only. A detailed survey has not been carried out, nor the services, appliances and fittings tested. Room sizes should not be relied upon for furnishing purposes and are approximate. If floor plans are included, they are for guidance only and illustration purposes only and may not be to scale. If there are any important matters likely to affect your decision to buy, please contact us before viewing the property.



FIND OUT MORE