



Oaktree Road, Bitterne Park

SOUTHAMPTON, SO18 1PL - £150,000

enfields

Oaktree Road

BITTERNE PARK, SOUTHAMPTON, SO18 1PL

A characterful one-bedroom first-floor flat in sought-after Bitterne Park, offering period features, spacious living, and no forward chain. Close to local amenities, green spaces, excellent schools, and superb transport links.

Situated on Oaktree Road in the sought-after area of Bitterne Park, this one-bedroom first-floor converted flat presents an excellent opportunity for buyers looking to add their own touch to a home with character. The property retains a selection of period features and offers a practical layout, with a spacious lounge/diner, separate kitchen, a well-proportioned bedroom, and a three-piece bathroom suite. With no forward chain, the property is ideal for those seeking a straightforward purchase.

Bitterne Park is a well-regarded residential area, known for its strong sense of community and convenient access to local amenities. Nearby Bitterne Park Triangle offers an array of independent shops, cafés, and essential services, while larger supermarkets and retail options can be found in Bitterne and Southampton city centre. Riverside Park, just a short walk away, provides expansive green space along the River Itchen, perfect for walks, cycling, and outdoor activities.





For those requiring transport links, the property is well placed for access to St Denys train station, providing regular services to Southampton Central, Portsmouth, and London Waterloo. The M27 motorway is also easily accessible, offering convenient routes towards Winchester, the New Forest, and beyond. Regular bus routes serve the area, ensuring excellent connections to the city centre and surrounding districts.

Education options are a key attraction in Bitterne Park, with well-rated schools nearby, including Bitterne Park Primary and the highly regarded Bitterne Park Secondary School. The area is also home to a range of nurseries and early years education centres, making it a practical choice for those planning for the future.

This property offers a fantastic opportunity for buyers looking for a home with character in a well-connected and popular part of Southampton. With its period charm, convenient location, and potential for improvement, it would suit first-time buyers, investors, or those looking to downsize without compromising on access to essential amenities and transport links.

Council Tax Authority: Southampton City Council

Tenure: Leasehold

Energy Efficiency Rating: TBC

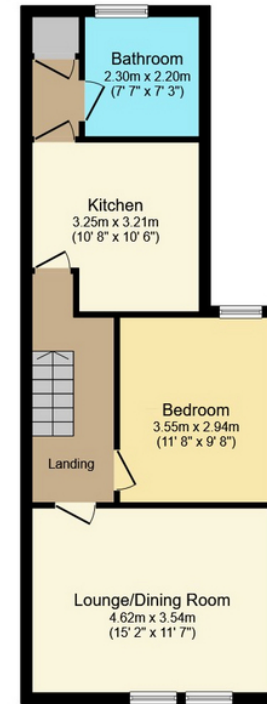

Floor Plan

Floor area 51.7 sq.m. (556 sq.ft.)

TOTAL: 51.7 sq.m. (556 sq.ft.)

This floor plan is for illustrative purposes only. It is not drawn to scale. Any measurements, floor areas (including any total floor area), openings and orientations are approximate. No details are guaranteed, they cannot be relied upon for any purpose and do not form any part of any agreement. No liability is taken for any error, omission or misstatement. A party must rely upon its own inspection(s). Powered by www.Propertybox.io



Enfields Southampton, 3 West End Road, Southampton, SO18 6TE
Tel: 02380 425 925 Email: sales@enfields-southampton.co.uk www.enfields-southampton.co.uk

IMPORTANT NOTICE: The details presented in these property particulars are believed to be precise, but they are intended to serve only as a general guide and must not be regarded as a formal offer or contractual agreement. Prospective buyers should not depend on these details as accurate statements or depictions of reality but should instead verify their correctness via their own inspections or other established means. We have not conducted an exhaustive survey, nor have we tested the utilities, appliances, or particular fixtures. Room dimensions must not be relied upon for carpeting and furnishing decisions. The measurements provided are estimated. No employee within Enfields has the power to make or offer any representation or guarantee about the property.

