



14 Wychwood View
Minster Lovell, Oxfordshire OX29 0ST

14 Wychwood View, Minster Lovell, Oxfordshire OX29 0ST

A 4 bedroom detached bungalow presented in excellent condition, situated on the edge of this popular village. The property is set in lovely, well tended, private gardens, and offers flexible accommodation with spacious rooms to include an entrance hall, cloakroom, living room, kitchen/dining room, either 3 or 4 bedrooms and a family shower room. The main bedroom has an ensuite and doors onto the rear garden, and the 4th bedroom could also be used as a second reception room or separate dining room. In addition there is double glazing, oil central heating, a garage and parking.

Mains services are all connected, except gas.

There is a pathway to the rear with joint access.

Ultrafast broadband is available.

Mobile & Data Signals - outdoor is likely for EE, O2, Vodafone & Three. Indoor is limited for EE, O2, Vodafone & Three.

Directions

Leave Witney via Burford Road (A4095) and proceed towards Minster Lovell. On entering Minster Lovell, turn left into Brize Norton Road. Take the first turning on the right into Upper Crescent. Continue along, turning right into Wychwood View. Bear left and the property can be found at the end of a pathway.

Minster Lovell Village

Minster Lovell is a good size village with a primary school and local shops, and is conveniently situated close to Witney and the A40 to Oxford, Burford and Cheltenham.

Draft details - may be subject to alterations. 23F25





ACCOMMODATION

Entrance Hall
Cloakroom
Living Room
Kitchen/Dining Room
4 Bedrooms
Ensuite
Family Shower Room

Double Glazing
Oil Central Heating

OUTSIDE

Good Size Gardens To The Front & Rear
Garage
Parking



Price £545,000 Freehold
WODC Tax Band D / EPC Rating: 50/E

14 Wychwood View

Total Approx. Floor Area 1201 Sq.Ft.
(111.60 Sq.M.)

All items illustrated on this plan are included in the
"Total Approx Floor Area" |

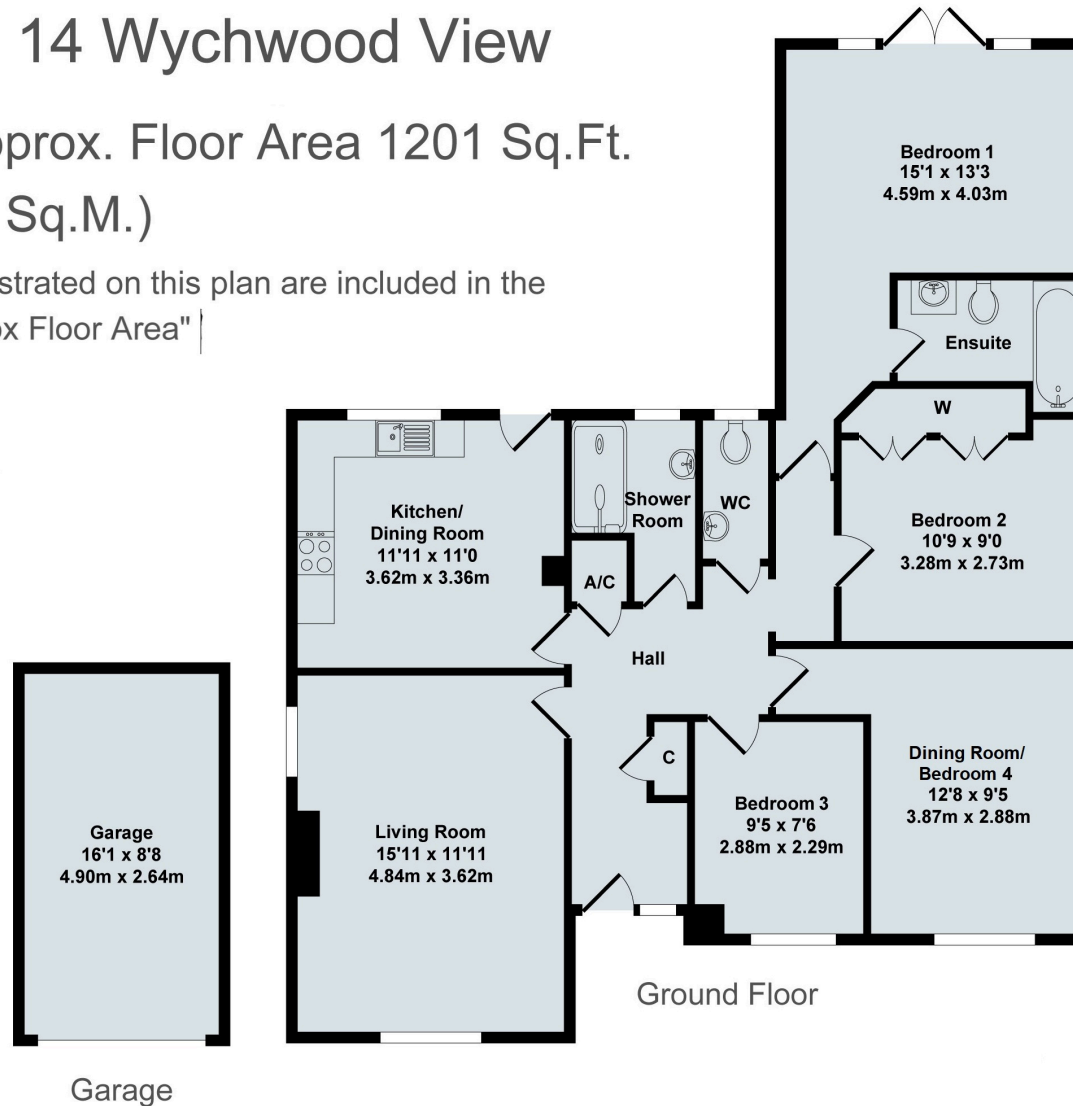

THOMAS
MERRIFIELD
SALES LETTINGS

Contact:

52 Market Square, Witney, Oxfordshire, OX28 6AF

Tel: 01993 772000 Email: witney@thomasmerrifield.co.uk

Importance Notice

Thomas Merrifield and their clients give notice that:

1. They are not authorised to make or give any representations or warranties in relation to the property either here or elsewhere, either on their own behalf or on behalf of their client or otherwise. They assume no responsibility for any statement that may be made in these particulars. These particulars do not form part of any offer or contract and must not be relied upon as statements or representations of fact.

2. Any areas, measurements or distances are approximate. The text, photographs and plans are for guidance only and are not necessarily comprehensive. It should not be assumed that the property has all necessary planning, building regulation or other consents and Thomas Merrifield have not tested any services, equipment or facilities. Purchasers must satisfy themselves by inspection or otherwise.