



Flat 11 Woodley House, 34 Woodley Green, Witney, OX28 1BF

Draft details - may be subject to alterations. Distances - Witney, Market Square c. 1.7 miles / Hanborough Train Station c. 5 miles / Oxford c. 12.7 miles

Pleasantly situated on the popular 'Madley Park' development, an appealing 2 bedroom, first floor apartment with an allocated parking space.

Accommodation comprises of an entrance hall, living/dining room, kitchen and a large bathroom (with both a bath and shower). There are the further advantages of double glazing and electric underfloor heating. The property is well placed for access to shops and other local amenities. Leasehold- 150 years from 2003. Current service charges: £2034.46 pa. Current Ground Rent: £311 pa.

**THOMAS
MERRIFIELD**

SALES LETTINGS

e. witney@thomasmerrifield.co.uk

t. 01993 772000

Price £219,950

www.thomasmerrifield.co.uk



Flat 11 Woodley House, 34 Woodley Green, Witney, Oxfordshire OX28 1BF

- Hallway
- Living/Dining Room
- Kitchen
- 2 Bedrooms
- Bathroom (with bath & shower cubicle)
- Entry Phone System
- Electric Underfloor Heating
- Double Glazing
- Allocated Parking Space
- No Onward Chain

Directions - Leave Witney town centre via Woodstock Road and take the last turning on the right hand side into Harvest Way. Take the first turning left into Woodley Green and continue around the green to Woodley House (which overlooks the green). O4G25

All mains services, with the exception of gas. Superfast broadband available. Mobile & data: Up to 83% performance ('Three').

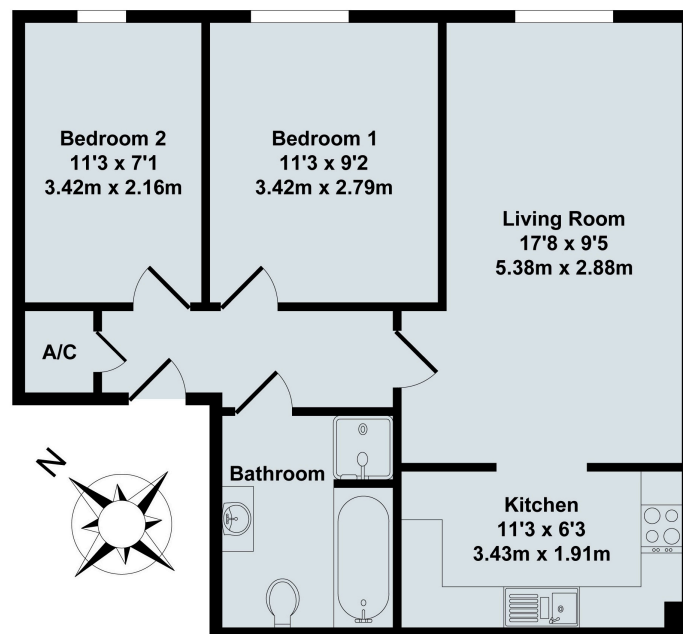

Flat 11, Woodley House

Total Approx. Floor Area 564 Sq.Ft. (52.40 Sq.M.)

All items illustrated on this plan are included in the "Total Approx Floor Area"

Local Authority:

WODC Tax Band C / EPC Rating: 84/B

Contact:

52 Market Square, Witney,
Oxfordshire, OX28 6AF

Tenure:

Leasehold -150 yrs from 2003 (128 yrs remaining). Current service charge £2034.46 & ground rent £311 (2025)

Tel: 01993 772000

Email: witney@thomasmerrifield.co.uk

Important Notice

Thomas Merrifield for themselves and their clients give notice that:-

1. They are not authorised to make or give representation or warranty in relation to this property, either on their own behalf or on behalf of the Seller. They assume no responsibility for any statement made in these particulars. These particulars do not form part of any offer or contract and must not be relied upon as statements or representations of fact.
2. Whilst every attempt has been made to ensure the accuracy of the floorplan contained here, measurements of doors, windows, rooms and any other items are approximate and no responsibility is taken for any error, omission, or mis- statement.
3. All areas, measurements or distances are approximate. The particulars are intended for guidance only and are not necessarily comprehensive. A wide angle lens may have been used in photography. Thomas Merrifield have not tested appliances or services and it should not be assumed that the property has all necessary planning, building regulation and other consents. Buyers must satisfy themselves with the property by inspection or otherwise.
4. Reference to any mechanical or electrical equipment does not constitute a representation that such equipment is capable of fulfilling its function and prospective Buyers must make their own enquiries.
5. They have no responsibility for any expenses or costs incurred by prospective Buyers in inspecting properties which have been sold, let or withdrawn. Applicants are advised to contact the Agent to check availability and any other information of particular importance to them, prior to inspecting the property, particularly if travelling some distance.