



Low Drive, Sutton Coldfield, B73 6

Guide Price £300,000



# Key Features

---

- Immediate 'exchange of contracts' available
- Being sold via 'Secure Sale'
- Bungalow
- Three Bedrooms
- Large living room with separate Kitchen
- Garage and driveway





*Being Sold via Secure Sale online bidding. Terms & Conditions apply. Starting Bid £300,000 Spacious 3-bed detached bungalow on Lowe Drive, Sutton Coldfield. In need of modernisation with huge potential. Driveway, garage & rear garden. Sought-after location near great schools, parks & amenities.*









Being Sold via Secure Sale online bidding. Terms & Conditions apply. Starting Bid £300,000

A rare opportunity to secure a spacious detached three-bedroom bungalow in one of Sutton Coldfield’s most desirable residential areas. Set on the sought-after Lowe Drive, this property is perfect for buyers looking to modernise, add value, and create a forever home in a premium postcode.

Set back from the road, the home offers a private driveway, garage, and a generous rear garden, making it ideal for families, downsizers, or investors alike.

Inside, the layout is surprisingly spacious and well-proportioned throughout. There are three good-sized bedrooms, a large open-plan living and dining room, and a spacious kitchen that could be reconfigured to create a stunning modern space. The property also benefits from a shower room and a separate W/C for convenience.

Although it requires updating throughout, the property has solid bones and endless potential – the perfect blank canvas to tailor to your own taste and lifestyle.

Lowe Drive is located in a highly desirable pocket of Sutton Coldfield, known for its peaceful residential streets, strong community feel, and close proximity to outstanding schools, local amenities, and green open spaces including Sutton Park. Excellent transport links and access to local shopping centres make this an



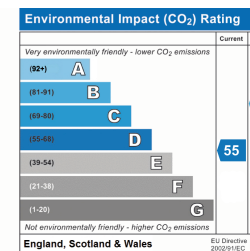
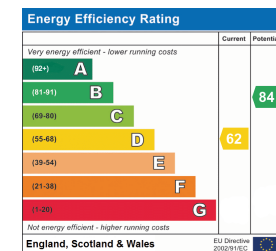
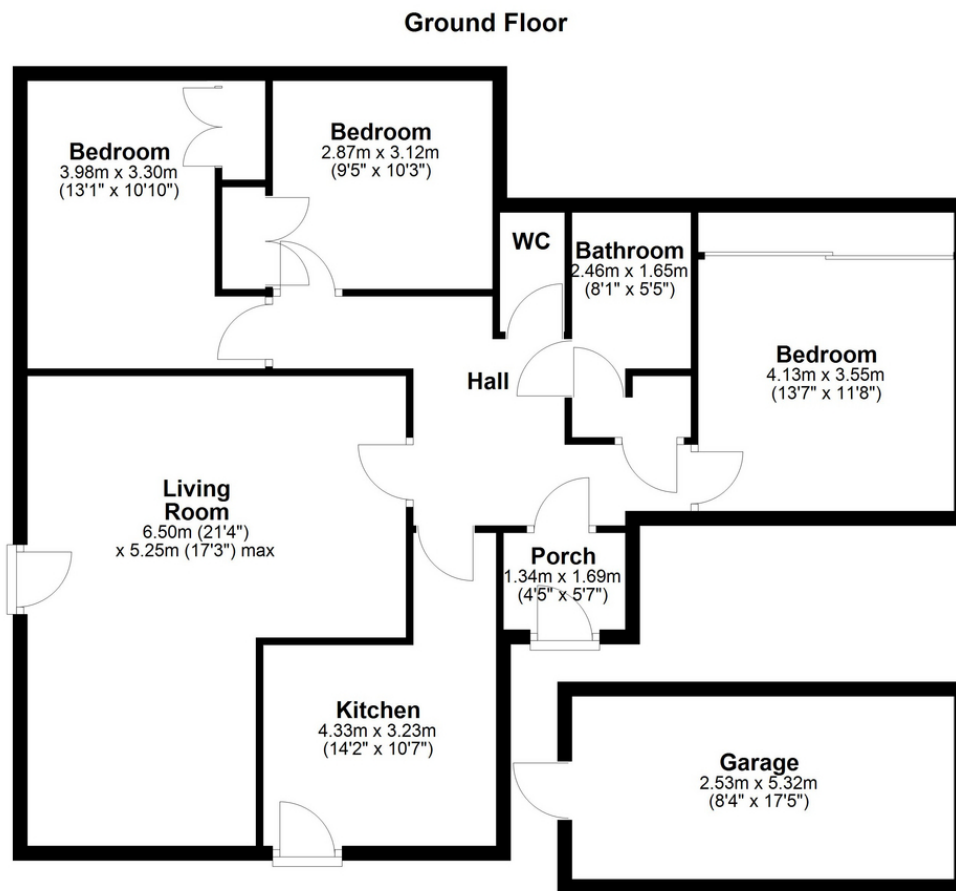

**Tenure Type:** Freehold  
**Council Tax Band:** E  
**Council Authority:** Birmingham City